

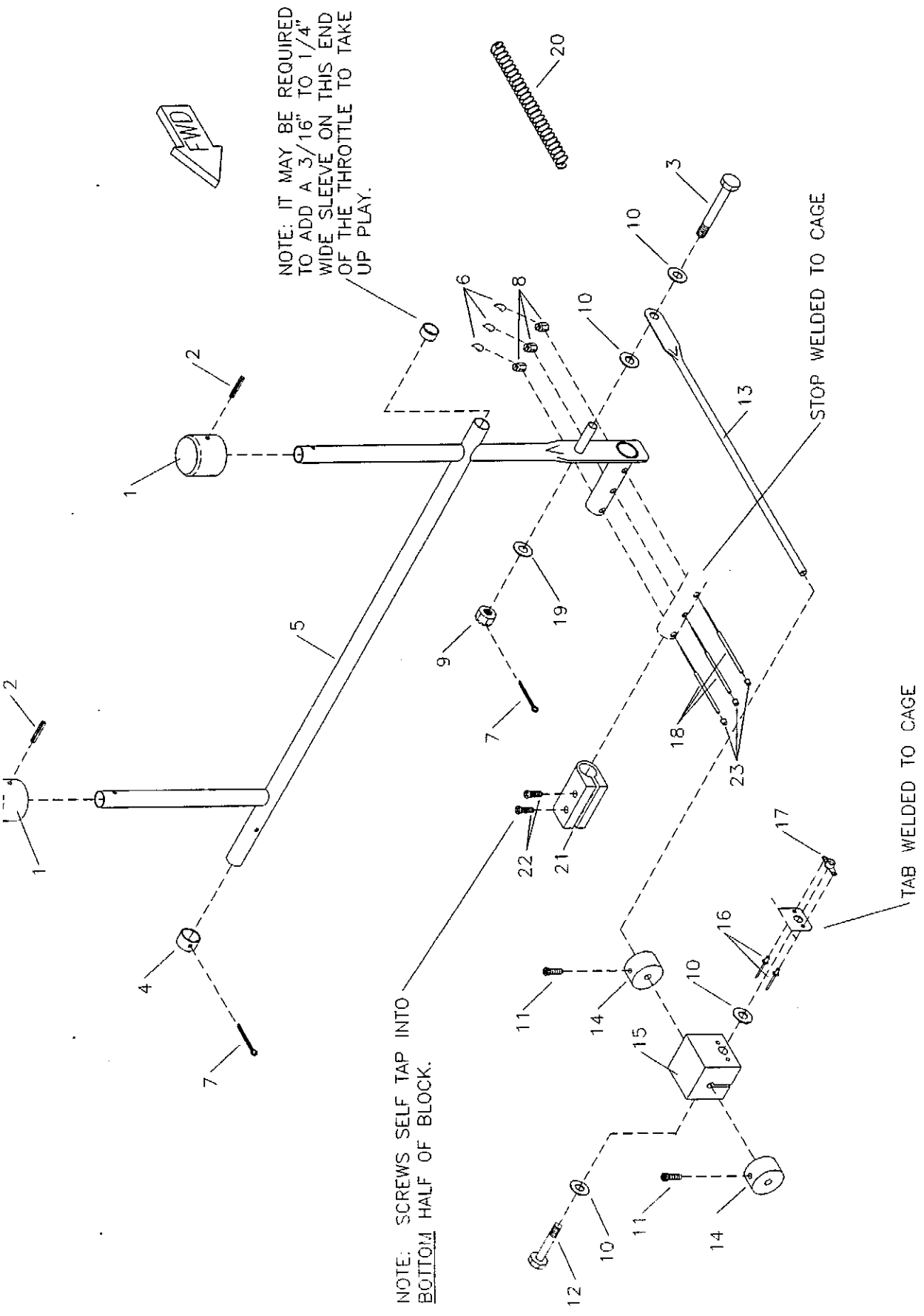

NOTE: IT MAY BE REQUIRED TO ADD A 3/16" TO 1/4" WIDE SLEEVE ON THIS END OF THE THROTTLE TO TAKE UP PLAY.



NOTE: SCREWS SELF TAP INTO BOTTOM HALF OF BLOCK.

STOP WELDED TO CAGE

TAB WELDED TO CAGE

RAMS S-6ES COYOTE II THROTTLE LINKAGE

MD1279